

NASA Lewis Ski Club

November 2011

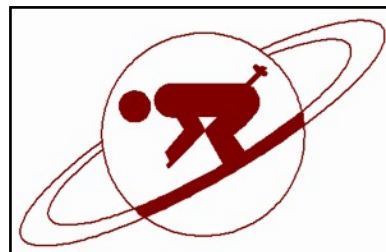

Next meeting
**Tuesday, Nov. 1, 100th
Bomb Group, Brookpark
Road**
**Larry Anderson will
speak on "Free Heel Gear"
(info on cross-country, tele-
mark, cross-country down-
hill, snowshoes etc.)**
**Board meeting: Tuesday,
Nov. 22, 5:30 p.m., Panera
Bread on Tiedeman Road**

Inside:

President's Message.....	2
List of day trips.....	3
Kelleys Island trip recap.....	4
Birthdays.....	4
Club activities.....	5
BM Open House recap	6
Other clubs' news.....	7
Steamboat & Tahoe fliers....	8-9
Wash. Hut Hopper flyer.....	10
Laurel Hill Flyer.....	11
Jay Peak trip flier.....	12-13
Movie night flyer.....	14
Quaker Steak ski show.....	15
Membership Application...	16
Week-long Trip Application..	17

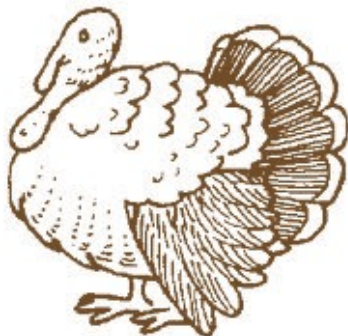

**Don't be a turkey! Renew
your club membership
for the 2011-2012 sea-
son before the price rises
after Nov. 15!**

**Remember to check out the flier for the trip to Jay Peak,
Vermont in March with two other clubs on pages 12-13!**

President's message...

Look Mom. It snowed! No kids, that's just frost. <sigh>. Did you know that the air temperature does not need to be below freezing in order for frost to form? While Ohio is starting to get frost, other parts of the country are starting to get snow. Colorado and Wyoming have even had their first big storm of the year. Snowstorms for the North East have also been predicted. With the rainiest year on record here in OH, if the trend continues, we are due for a snowy winter.

This season we have a packed schedule for our club meeting activities. In October you heard about photography on the slopes. You should now be primed for photography on the slopes. Keep taking photos throughout the year, as we plan to hold a photo competition after the snow season is over. Special thanks to photo enthusiast and fellow skier Doug Waltman for presenting on Ski Photography at the Oct. club meeting! (see below for more) In addition special thanks to all who helped organize the Oct. meeting, especially Victoria Wise for all her efforts in coordinating the speaker.



In November our featured club meeting activity is our very own Lewis Ski Club expert member Larry Anderson, who will explain different types of "free heel" gear for the snow. (cross-country, telemark, back country gear). In December, Gordon from Geiger's will present on packing for the ski/snowboard trip and for a day on the slopes. The December meeting will also host the annual White Elephant, so keep your eye out for those "Elephants". Please note: Due to the packed schedule for the December meeting, the club business will be kept to a minimum. Be sure to watch the newsletter, the web page and your email to keep up to date on the club happenings.

During the Boston Mills Open House, the club had a number of members help to talk to prospective new members. Special thanks to everyone who helped behind the scenes. All of the club members benefit from your hard work, and without you these activities would not happen. Special Thanks to: Emil Bagi, Linda Elonen-Wright, Lisa Ferenc, Mark Hyatt, Mike Kaltenstein, Lori Manthey, Ray & Jan Neumann, Gloria & Tom O'Donnel, Allen Porter, Dave Root, Aaron Swank, Therese Telzrow, Victoria Wise, Allison Wood for helping with the open house. If somehow I missed your name and you helped out at the Open House, please let me know so that I can be sure you are properly recognized.

Don't forget, the Snow is on the Way!

—Aaron

Upcoming day trips

Here is the list of day trips for this upcoming season, a few still need trip leaders. Start filling out those vacation forms now!

Holiday Valley I – Fri, Jan 6, Seven Springs –Fri, Jan 20, Holiday Valley II –Fri, Feb 3, Holiday Valley III –Fri, Feb 17, Holiday Valley III –Fri, Mar 9

October speaker gives photography tips

Forget magazine perfect ski pictures? Didn't Doug Waltman come to the October meeting to tell us how to take them? He did bring a really heavy backpack full of the necessary equipment for us just to lift. He told us, we probably would need to hike with it, up to the "best" spot and spend the day taking a staged shot over and over, only to spend more time editing the photo----instead of skiing! Doug's right, it's not that we can't, it's really not worth the effort. We go on ski trips to ski.

Now that the pressure is off, the good news is: by taking lots of photos following the "Rule of Thirds" before 11 am, using a decent camera with RAW capacity, kept warm in an inside pocket, we can take great pictures. We got tips about exposure, panoramas, video clips and all types of shots, with wonderful photo examples. Doug even brought a hand out with the information. There was no quiz at the end. The test will be the trip pictures this spring. Look forward to a ski trip photo contest and take loads of pictures! -Victoria Wise

Club officers

Position	Name	Email @lewisclub.org
President	Aaron J. Swank	president
Alpine V.P.	Dave Root	alpinevp
Nordic V.P.	Allen Porter	nordicvp
Activity V.P.	Ray Neumann	activity
Recorder	Barb Knipple	recorder
Publicity Director	Allison Wood	publicity
Treasurer	Janet Dubas	treasurer

Committee Chairs & Trustees

CMSC Representative	Victoria Wise	cmssc
Racing	Lisa Lambert	race
Membership	Lisa Ferenc	membership
Web curator	Linda Elonen-Wright	webcurator
Alternate web curator	Lisa Lambert	webcurator
Trip	Tom Vannuyen	tripchair
Trustee	Lori Manthey	trustees
Trustee	Mark Hyatt	trustees
Trustee	Bruce Frankenfield	trustees

Kelleys Island Recap

It was a picture perfect day, Saturday, Aug. 20, for a small group of us, Lori and Mark Manthey with their son, Lisa Ferenc, Connie Dean, John Zoldi, Trudy Graham, Matt and Janet Dubas, on the Kelleys Island bike trip. The ferry rides from and back to Marblehead were smooth and scenic on our Lake Erie. We biked around the island stopping at the Glacier Grooves, state park, public beach, and the pavilion on Addison St for a Big Band concert by the North Coast band. We watched the Kelleys Island homecoming parade and had lunch at the Kelleys Island Brewery and wine tasting at the Kelleys Island Wine Co. The bike ride on the north shore loop trail was short lived when the mosquitoes started eating us alive and we turned back to the trail entrance.

Submitted by Janet Dubas



Happy November Birthday to:

Emil Bagi Carl Blaser Eric Carlberg Robert Czarnecki

Connie Dean Linda Elonen-Wright Tom Jones

Allen Porter Jim Slifka Kenneth Slone

Tom Vannuyen Shawn White Colette Willins



NASA Lewis Ski Club Activities

With the holidays & the ski season fast approaching, there's not a whole lot of activities coming up to report on. If you would like to volunteer to have a get together after work or an event to share with fellow club members, contact Ray Neumann or send an email to activity@lewisskiclub.org

Saturday, November 19th – The Warren Miller Ski Fest at The Akron Civic Theater Skifest starts at 6:30 p.m. The Movie "...Like There's No Tomorrow." begins at 8:00 p.m.

Tickets can be bought for \$11.00 each in advance or \$9.90 each for groups of 12 or more; \$15.00 per person on day of the show.

Wednesday, December 28th - Metro Ski Council's Christmas Party at Quaker Steak on Canal Road in Independence

Don't Forget: White Elephant Exchange at the December Club Meeting

All you have to do to participate is bring a very nicely wrapped "white elephant" to the club meeting. The "white elephant" can be anything you've had in your closet that someone else could use or just a regift that you don't really want. So, you bring your gift; check in, get a number and place the gift on the table. The number you get will determine the order in which you get to select another gift from the table during the exchange. You open it, and then you get one chance to either keep the gift or steal from one of the previous openers! Please join in on the fun this year. .

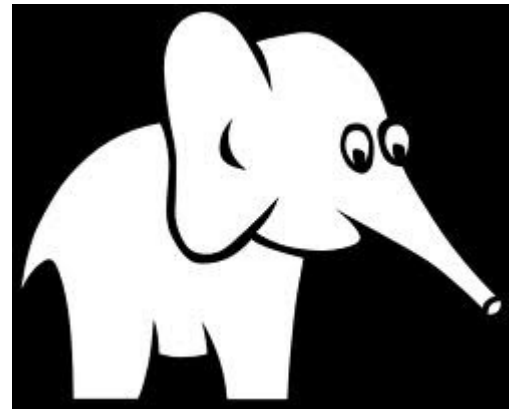

Beginners Day Trip to Boston Mills



Have a friend or know someone thinking about getting into snowboarding or skiing? During the holiday season this year (Dec. 27-30, exact date TBD), look for a Lewis Ski Club Day Trip to Boston Mills. This outing will be open to anyone wishing to take advantage of group discount rates, but will also be of interest to people new to the snow. With the help of the expert instructors at Boston Mills, our group rate will include a group lesson to interested individuals as part of the package. Tell your friends to stop thinking about getting into the sport, and take advantage of this opportunity. Trip Leader: Warren Knipple.

Boston Mills Open House Recap

The Boston Mills Open House took place from Oct. 14-16 at the ski area, and included demonstrations and two tents full of gear. The one tent had used equipment and clothing as part of the ski swap sale and the other tent had new gear, with much of it discounted as it was from the previous season.

Along with shopping, the Lewis Ski Club had a booth at the event, where several volunteers handed out brochures about the club and answered questions about upcoming trips. We were in front of the fireplace right on the path to where the free pop and popcorn was being given out.



Thank you to the booth volunteers, which included Dave R., Allison W., Therese T., Mike K., Lisa F., the Neumanns and Gloria O. among others.

There were also other clubs represented, including Fagowees, Warren Ski Club and Suburban Ski Club and it was interesting to see what kind of trips and activities they had planned for the next year. Anyone up for a clam bake or pig roast? Discounted Pick-a-Day passes were also available for sale at the lowest price of the season.

Anyone who ventured outside from the tents or lodge had the chance to see skiers and snowboarders try their luck on rails set on imported ice and snow. Unfortunately for them, most of their attempts had them getting up off the ground. There was also a bull riding station along with food and drinks available for sale.

-Allison Wood (top photo by Emil Bagi)



News from other clubs

The Three Trackers of Ohio is looking for ski buddies to help instructors. The Three Trackers of Ohio is a volunteer non-profit organization dedicated to the promotion of adaptive recreational sports to persons with or without physical disabilities. On the slopes volunteers should be skiers with upper intermediate to advanced skier capabilities. Non-skiing volunteers are also welcome for lift loading. A free lift ticket is provided for the day of participation for ski volunteers. Lessons are typically on Tuesdays from 6-9pm and all day on Sundays. Contact and more information can be found on the Three Trackers web page at http://www.3trackers.org/general_information.html under "Volunteers".

Hilltoppers XC Ski Swap Fundraiser

Hilltoppers XC will be holding a nordic ski swap fundraiser on Saturday, November 12th. They are seeking both donated and consignment items for the swap, so if you want to make room in the garage or just want a new pair of skis, this is your best chance! It will be from 3:30-5:30 p.m. At Red Wing Cabin in the Hinckley Reservation of the Metroparks.

<http://www.clemetparks.com/pdf/Hinckleytrail.pdf>

It is located on West Dr. - driveway entrance on the right before the Hinckley Lake boathouse. Proceeds will benefit junior skiers enrolled in Hilltoppers XC seeking to participate in regional, national and international events. There will also be a raffle and food for sale. Skiing items can be purchased using checks or cash, no credit cards can be accepted.

If you have items to sell, e-mail a list to hilltoppers@ohionordic.org. For updates, visit www.ohionordic.org.



Knipples take Greek cruise with guest speaker's company

Last June, Sam Jordan came to speak to our club about his See the World Tours. Warren and I decided to go on the Greek Cruise in early October. We boarded the Star Princess, a beautiful ship with 16 decks. We visited Dubrovnik, Croatia; Corfu, Rhodes, Olympia, Athens, Mykonos, and Santorini, Greece; Ephesus, Turkey; and Venice, Italy. The weather was sunny and mild. We met wonderful people, many of whom were skiers from the Warren-Youngstown area. We avoided strikes and earthquakes, had marvelous food and service on the ship, and saw beautiful sights. We highly recommend Sam Jordan's trips. Check out his website sam@seetheworldtours.

-Barb and Warren Knipple

The NASA Lewis Ski Club Presents...



Steamboat.

January 14 – 21, 2012

\$1,240 per person*

Trip Includes:

- Lodging – The Phoenix - 7 nights, 4 people per 2 bedroom, 2 bath condo
- Lift tickets – 5 days of skiing at Steamboat (Ski 6th day for only \$42 more)
- Roundtrip airfare from Cleveland to Hayden (Steamboat airport)
- Ground transportation from airport to lodging and back to airport
- Free shuttle service into town and around resort, heated garage for ski storage
- Complimentary welcome party
- Walk to lifts

Payment schedule:

\$450 due now, non-refundable

\$400 due by September 15, 2011

\$390 due by November 1, 2011

Send deposit check with trip application and agreement form to:

Lori Manthey
319 Brookshire Oval
Hinckley, OH 44233

Make checks payable to:

Lewis Ski Club, Inc.

Trip Leaders:

Lori Manthey 216-633-7143

Shelli Sharp: 440-915-5361

Steamboat2012@lewisskiclub.org

Note: Must be a member of the Lewis Ski Club. For membership forms, visit our website at <http://www.lewisskiclub.org>

\$10 single/\$15 family
(please send a separate check for membership)

Optional Trip Insurance Available

*The price does not include any additional fuel surcharges, baggage fees, or airport fees which may be imposed prior to the date of travel.

Ski North Lake Tahoe Squaw Valley & Alpine meadows & Northstar with the NASA Lewis Ski Club

Sat Feb 11 - Sat Feb 18, 2012

\$1224 per person includes:

Lodging – Silver legacy casino, Reno, Nevada

*7 nights (Sat. to Sat.), dbl occ. per room.

*Lift tickets – 5 days (3 days Squaw Valley, 1 days Alpine Meadows, 1 days Northstar)

6th day skiing to any resorts is available for an additional cost

*RT Airfare from Cleveland to Reno on American Airline

*RT Ground transportation from Reno Airport to the Silver Legacy

*RT Ground transportation from Hotel to Ski Resorts.

** Complimentary welcome party upon arrival.

** Complimentary breakfast daily.

** Complimentary closeout party at the end of the week.

** Indoor HEATED pool, LARGE hot tub.

As always, complimentary parting gifts and raffle items on the bus ride home!!!

Trip leaders: Tom Vannuyen (216-433-3851 work) (440-376-1503 cell)

Dave Root (440-454-0475 cell)

E-Mail: tahoe2012@lewisskiclub.org

Payment schedule:

\$408 Due now, non-refundable

\$408 Due by September 16, 2011

\$408 Due by December 9, 2011

Send deposit check and trip agreement form to: Tom Vannuyen

21000 Brookpark Rd MS 86-12

Cleveland, OH 44135

Make Checks payable to: Lewis Ski Club, Inc.

Note: Must be a member of the NASA Lewis Ski Club - \$10 single/ \$15 family.

***** For additional information, trip application, and membership forms, please visit our website at:**

<http://www.lewisskiclub.org>

*** The price does not include any additional fuel surcharges, baggage fees, or airport fees which may be imposed prior to date of travel.**

Washington Hut Hopper

by NASA Lewis Ski Club
Feb. 25th 2012 – Mar. 4th 2012

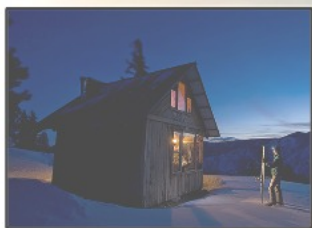

Rendezvous Huts

Payment: \$700 per person*

Airfare Extra*, ~\$500 - \$650
\$350 Due by Dec 1
\$350 Due by Jan 13

Send Trip Application & Agreement
Form and Payments to:

Lewis Ski Club
Trip: WA Hut Hopper
21000 Brookpark Rd.
Cleveland, OH 44135

Make Checks Payable to:
"Lewis Ski Club, Inc."

Trip Includes:

Lodging: 4 Nights Huts + Meals,
2 Nights Cabin, 2 Nights Hotel

Ground Transportation to Nordic
Trail System from Spokane, WA

Trail Passes: Six Days on the
Methow Valley Nordic Trail System &
Options for Off-Trail Travel

Trip Leaders:

Aaron Swank, Carl Blaser
huthopper2012@lewisskiclub.org
216 369 7542

* Price does not include any additional fuel surcharges,
baggage fees, or airport fees which may be imposed
prior to date of travel. Airfare extra, to be arranged.
Lewis Ski Club Membership Required. For membership
forms, visit the club website at <http://lewisskiclub.org>

Additional Trip Details

Hut Hopper Trip between the 5-hut system in North Cascades near Winthrop, WA at 4000 ft elevation.

This is an eight person ski trip, primarily for traditional cross country skiing and skating with opportunities to use telemark skis, and venture off-trail by ski or snowshoe.

This trip is considered intermediate level for skiing and winter travel skills. Although the trails are typically groomed, participants must be comfortable skiing on un-groomed terrain.

Travel will be primarily on the Rendezvous trail system, consisting of 25 km groomed trails with additional off-trail snow opportunities. Trip also includes the opportunity to enjoy an additional 200 km of groomed trails on the Methow valley trail system.

Trip lodging itinerary: 1 night hotel, 4 night huts (3 different huts-Heifer, Cassal, Cassal, Rendezvous) 2 nights cabin in Methow Valley, 1 night hotel. Dinner in the Huts will be cooked and organized as a group, while breakfast and lunch will be based more on individual basis when trip itinerary permits.

Approximate distance between the Rendezvous Huts:

Cub Creek Parking to Heifer: ~6 miles
Cassal to Rendezvous: ~3.8 miles

Heifer to Cassal: ~9.1 miles
Rendezvous to Cub Creek Parking: ~6 miles

**Weekend Trip March 2nd through the 4th, 2012.
Laurel Hills Lodge in Laurel Hill State Park
Located in Somerset County PA.**



Join the NASA Lewis Ski Club for a Weekend Trip to this spacious lodge located in the beautiful Laurel Highlands. It's the perfect trip for cross country and downhill skiers and even those who don't do either as it's located close to all kinds of cross country trails, Seven Springs, Hidden Valley and many other attractions. You can find more information about the Laurel Highlands at their website @ www.laurelhighlands.org

The lodge holds a maximum of 14. Bedding preferences will be honored on a first come/first serve basis. Cost is only \$90 per person. This includes the lodging, breakfast each morning and a Saturday night dinner. You are on your own for lift tickets, trail fees and transportation. Bring your own bedding. For more information on the lodge and what it includes, see their website at www.dcnr.state.pa.us/stateparks/parks/laurelhill/laurelhilloodge.

Contact Therese Telzrow at 216.548.0359 for more information. To sign up, complete a Trip Application and mail it along with your check payable to Lewis Ski Club and send it to:

Therese Telzrow, 1203 Ethel Ave, Lakewood OH 44107

ANNOUNCING:

JAY PEAK & Stowe

VERMONT

MARCH 18-24, 2012



BROUGHT TO YOU BY:



ONLY \$899!!!

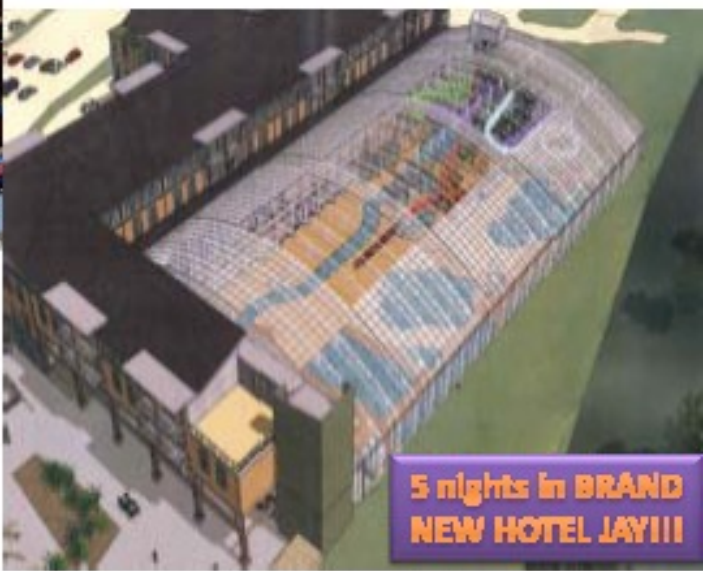

5 nights in BRAND NEW HOTEL JAY!!!

PACKAGE INCLUDES:

- ❖ Luxury accommodations including Breakfasts (5) & Dinners (6) with choice of several restaurants
- ❖ 5 Days of lift tickets (1 Day Stowe)
- ❖ Open ice skating (pre-set times), fitness center, wireless internet
- ❖ New, 60,000 sq. ft. indoor water park with hot tubs, lazy river, swimming holes, flow rider surfing, water slides, and mezzanine bar & restaurant (unlimited access only \$50 for the entire week!!!)
- ❖ 2 hour daily group lessons at Jay Peak
- ❖ Round-trip motor-coach transportation
- ❖ Parties, drinks, snacks & prizes

See reverse for more information and sign-up instructions

Bus Transportation

Our bus leaves early Sunday AM, March 18th, from the Holiday Inn, on Beta Dr. in Mayfield Heights, just east of I-271 at the Wilson Mills Road Exit. The amenities on the bus include a large selection of breakfast items, a gourmet box lunch via Whole Foods, and snacks and beverages available throughout the trip. The bus returns on Saturday AM, March 24th.

About Jay Peak

Jay Peak, with a vertical of 2,153 feet, is located in northern Vermont a few miles from the Canadian border. It has been known for its unbelievable terrain, incomparable glades, and abundant natural snowfall. It has the most snow in eastern North America, averaging 355" per year. Vermont's only aerial tramway is one of 8 lifts accessing 385 acres of terrain, including 76 trails and 4 terrain parks for skiers and riders of all abilities. Jay Peak's boundary-to-boundary woods policy makes it a favorite among advanced skiers and riders but the glades aren't for experts only. The mountain also has the most beginners and intermediate tree skiing in the East. Check out Jay: <http://www.jaypeakresort.com>

About Stowe Mountain

Longest Vertical Drop: 2,160'; Total Number of Trails: 116 (16% beginner, 59% intermediate and 25% expert); Skiable Acres: 485; Total Lifts: 13

RESERVATIONS:

Make check payable to your chosen ski club & mail to the appropriate club rep below with a completed Application & Agreement form.

PAYMENT SCHEDULE:

\$300 Deposit	November 1, 2011
\$300	December 1, 2011
\$299	January 1, 2012

	 NASA Lewis Ski Club	
http://xnone.com/erieshoreskiclub.org	www.lewisskiclub.org	www.suburbanskiclub.org
Mike Hexter	Shelli Sharp	Joe Sullivan
440-590-5990 between 8:30a & 8:30p only	440-915-5361	216-932-3636
michaelhexter@howardhanna.com	jaypeak2012@lewisskiclub.org	president@Suburbanskiclub.org
1693 Elm Drive Avon, OH 44011	2744 Hampton Rd Rocky River, OH 44116	2775 Derbyshire Rd Cleveland Hts, OH 44106

Movie Night with the NASA Lewis Ski Club

Capitol Theatre Friday, November 4, 2011

1390 W 65th St., Cleveland OH 44102



Join us for a fun evening starting with a light meal at Luxe at 5:30 located at 6605 Detroit Ave.

If you can't make it for dinner then meet us at 6:45 at the Capitol Theatre for the 7pm showing.

Movie to be determined.

RSVP to Therese Telzrow at 216.548.0359

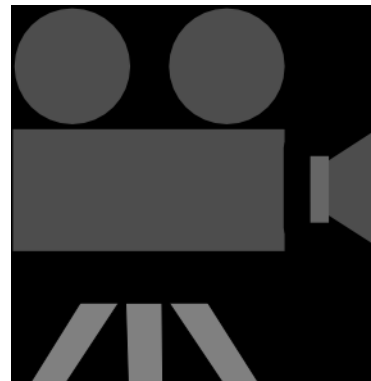

**QUAKER
STEAK
& LUBE**



Snow & Ski Show

Thursday, Dec. 1st at 6-9pm

**FREE
ADMISSION!**

Bring a Coat
for Coats for Kids
& receive double registration
forms to win prizes

Door Prizes & Giveaways

**Local Vendors and Ski Resorts
Will be attending**

Complimentary Hors D'ouerves

BluePrint Entertainment



Valley View, OH • 216.986.WING
www.quakersteakandlube.com

2011 - 2012 NASA SKI CLUB MEMBERSHIP

(OCTOBER 1, 2011 - SEPTEMBER 30, 2012)

Name:(first) _____ (last) _____

Home Phone: _____

Work Phone: _____

Home address:
Street/Apt.: _____

City: _____ St: _____ Zip: _____

NASA Lewis Ski Club publishes a Member Directory containing names, addresses, email addresses, and phone numbers of the members. It is in hard copy only and made available at meetings and upon request of other club members only. Do you consent to having your contact information included?

YES _____ NO _____

NASA Mail Stop(If applicable): _____

NORDIC Skiers check box if you wish to be included on a notification list for impromptu nordic ski outings.

Your Birthday: ___/___ (MONTH / DAY)

<p>Type of membership: Check TWO Types)</p> <p>Single(\$10) _____ New Member _____</p> <p>*Family(\$15) _____ **Renewal _____</p> <p>*A FAMILY MEMBERSHIP is defined as: “a member and spouse and/or DEPENDENT children”.</p> <p>**Renewal rates for current members increase after November 15th to \$15.00 for single and \$20.00 for family. New members pay the lower rate no matter when they join.</p>	<p>Please list eligible Family Members:</p> <table border="1"> <thead> <tr> <th>Name</th> <th>Age-Kids Only</th> <th>Birthday (M/D)</th> </tr> </thead> <tbody> <tr> <td>_____</td> <td>_____</td> <td>___/___</td> </tr> <tr> <td>_____</td> <td>_____</td> <td>___/___</td> </tr> <tr> <td>_____</td> <td>_____</td> <td>___/___</td> </tr> <tr> <td>_____</td> <td>_____</td> <td>___/___</td> </tr> </tbody> </table>	Name	Age-Kids Only	Birthday (M/D)	_____	_____	___/___	_____	_____	___/___	_____	_____	___/___	_____	_____	___/___
Name	Age-Kids Only	Birthday (M/D)														
_____	_____	___/___														
_____	_____	___/___														
_____	_____	___/___														
_____	_____	___/___														

E-mail: As of 2011, we are sending the newsletter out only via e-mail since it reduces both labor and postage costs.

E-mail address: _____ (please print legibly)

Release: I/We, single/family membership, acknowledge that many of the activities and events organized and sponsored by the Lewis Ski Club, Inc., in particular participation-type athletic activities, are dangerous and hazardous and can cause damage, injury and death. In consideration of becoming a member and/or renewing my membership I/we assume any and all risks of participating in such activities, including the risk of damage, injury and death, and I/we release Lewis Ski Club, Inc., its members and officers, from responsibility and liability therefore. This Release shall remain in effect while I/we am/are a member(s) and when and while I/we participate in any such activity, and even if Lewis Ski Club, Inc. is negligent.

 X _____

(Complete and return with dues to Lisa Ferenc, MS:301-4, NASA Glenn Research Center, 21000 Brookpark Road, Cleveland, OH 44135 - Make checks payable to: Lewis Ski Club, Inc.)

**Lewis Ski Club
Week Long Trip Application and Agreement**

The undersigned participant applies to participate in the Lewis Ski Club trip described below, subject to the following terms and conditions:

- 1. DEPOSIT:** The required initial deposit for this trip must be paid and submitted along with a signed Trip Application and Agreement. Balance shall be due and payable in accordance with payment schedules established by Lewis Ski Club.
- 2. WITHDRAWAL & CHANGE:** Lewis Ski Club may withdraw any trip from its schedule at any time; may refuse to accept or retain any person as a participant at any time for any reason; and may change the itinerary at any time.
- 3. RESPONSIBILITY:** Lewis Ski Club is acting gratuitously for the applicant and shall not be responsible or liable for any loss of damage to baggage, property, or for any loss, injury, death, accident, delay, inconvenience or any other loss occurring during or occasioned by applicant's participation or lack of participation in any trip. Trip participants ski and/or snowboard at their own risk. It is the injured skier's/snowboarder's responsibility to report to Ski Patrol for treatment or referral to hospital/doctor. If unable to accompany the club on return trip as planned, the injured party is responsible for arranging their own transportation for the return trip.
- 4. IDENTIFICATION:** Each participant is responsible for having and taking with them a valid, current, government-issued, photo ID. For trips out of the USA, participants are responsible for having up-to-date and valid passport. When required, participants are also responsible for having up-to-date and valid visa(s).
- 5. MINORS:** Any minor's participant Trip Application and Agreement must be co-signed by his/her parent or legal guardian. The minor must be accompanied on the trip by a parent or legal guardian or their designee who shall be wholly and fully responsible for said minor's conduct and well being.
- 6. PAYMENT:** All payment checks shall be payable to "Lewis Ski Club, Inc."
- 7. CANCELLATION:** If the participant cancels out of the trip, then the participant forfeits their rights to any and all payments made to Lewis Ski Club for this trip. Cancellation by participant means and includes: (a) failure to abide by the terms of this agreement; (b) notice by participant of intent to cancel; (c) participant's failure to make timely payments; (d) participant's failure for any reason to meet departure or return of the trip.
- 8. ELIGIBILITY:** Lewis Ski Club membership is required to participate.
- 9. EXTRA FEES:** Price does NOT include any additional fuel surcharges, baggage fees, or airport fees which may be imposed prior to the date of travel.

Print clearly Trip: _____

Applicant Name: _____

(MUST be as it appears on Drivers License/Passport (*for airline ticketing*))

Address: _____

Birth Date(Month/Day/Year)(needed for airline booking):

Phone w/area code:

(H) _____ (W) _____ (Cell) _____

Email address: _____

Emergency contact: (Name) _____

Phone w/area code: (H) _____ **(Cell)** _____

NASA Lewis Ski Club member? Yes / No (If NO, membership available for \$10-single/\$15-family)

Optional Trip Insurance? Yes / No (Information will be forwarded to you)

I have read and agree to all the terms of this Agreement, and waiver of liability, as of this date.

Signed in Agreement: _____ **Date:** _____